

# ΩmegaPost

Phone: +1.210.736.4477  
www.ImpactRecovery.com

## IMPACT recovery SYSTEMS™



**NTPEP  
TESTED  
200+  
IMPACTS  
AT 70  
MPH**

### BEST HIGH SPEED MANAGED LANE SOLUTION

- No fasteners to corrode
- Simple installation and replacement
- Durable, high speed performance
  - Heavy load crash tolerant
- Type V Super high intensity sheeting
  - 100% made in the USA
  - MUTCD compliant
- Category 1 Self Certified Device
  - Patent Pending



# ΩmegaPost

## PRODUCT SPECIFICATIONS



OmegaPost is a Category 1 small and light weight device with no attachments. Products such as these have been in common use for many years and are known to be crash worthy by testing of similar devices and years of demonstrable safe performance.

### RECOMMENDED USES

Managed Lanes, HOV Lanes, Bike Lanes, Urban Restrictions, High Speed Traffic, Corrosive Environments

### POST OPTIONS

Open top, Cap, or Long Squeeze

### SHEETING COLORS

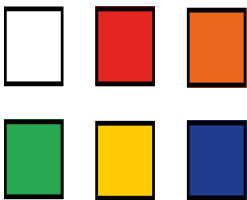

### POST COLOR OPTIONS



### BASE OPTIONS

OmegaPost™ can only be used with the Quarter Turn Surface Mount base in black (standard) or white/yellow



### BASE REFLECTORS

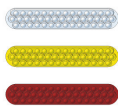

| ΩmegaPost Delineator  | Height            | Post Diameter | Post Colors             | Optional Sheeting                   | R. Sheeting Type                                  | R. Sheeting Colors                        | Base Type                       |
|-----------------------|-------------------|---------------|-------------------------|-------------------------------------|---|---|---------------------------------|
| ΩmegaPost 2" Open Top | 28"<br>36"<br>42" | 2.375"        | Yellow, Orange or White | Two 3" bands of reflective sheeting | Type V High Intensity Abrasion Resistant Sheeting | White, orange, yellow, red, green or blue | Surface Mount Quarter Turn Base |

*\*Base and base mounting hardware is sold separately. Post spring type must be specified at time of order. \*\* Protective Bollard height is based on post height.  
\*Open Top post is left with a smooth cut, open top*

### TWO METHODS OF INSTALLATION:

#### 1. ANCHOR KIT



#### 2. EPOXY KIT - HIGH SPEED APPLICATION

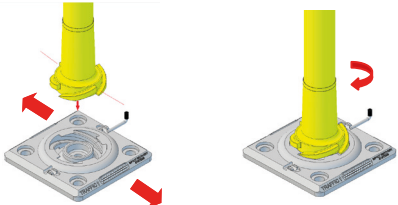

1. Insert the threaded post into base with holes aligned 90° to keeper pin slot.
2. Push down to insert the post and rotate clockwise until fully seated.

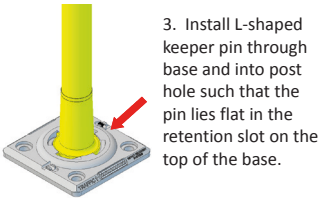

3. Install L-shaped keeper pin through base and into post hole such that the pin lies flat in the retention slot on the top of the base.

